

Best European Policies, Analysis and Transference in PHS

Programme for Employment and Social Solidarity — PROGRESS.

BESPAT

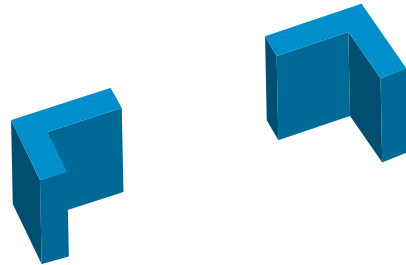



BES PAT

Best European
Policies, Analysis
and Transference
in PHS





PHS

Why this project.

Employment in the EU health and social care sectors is growing fast due to population ageing and an expansion of services to better meet quality requirements and rising demand for personalised care and professional social services. This rapid expansion (twice the employment growth as compared to the rest of the economy) suggests these sectors will remain a key driver for new jobs in the years to come. To exploit this job creation potential, these sectors have to overcome several challenges.

The work in this area has low productivity, traditionally Personal and Household Services (PHS) are provided by and within the household, mostly by women. These women must frequently choose between their professional and family life, and they have usually to give up their professional life.

Why this project.

The work of women would have higher productivity ratios if they could come back to the labor market and to develop their work in the fields in which they have been trained and they are specialized. The project will allow developing new policies that increase productivity in the labor market, based on the Best Practices analyzed.

This project will be developed by entities belonging to Social economy and networks of entities concerned with them. Social economy companies are the entities with the greatest impact in this sector, particularly in the PHS and telecare, residential and day centers. Among the features of the Social Economy companies to cover those gaps and deficiencies that the sector faces are included: the wide territorial coverage with these businesses, environmental knowledge, experience, quality of service provided and the ability to manage human capital, which results in high quality jobs. Due to it, this consortium assures the success of the project.



Partners.

The project Consortium is composed by organizations formed by private companies of the social economy sector with a high relevance in the public sector, belonging to national advising boards (CONFESAL and SNS), and networks of local authorities, associations of local authorities, regional authorities and ONGs and Universities (DIESIS, REVES, ALDA). Among their members there are private employment services, SMEs specialized in PHS and Foundations whose objective is to promote social justice policies linked to the achievement of gender equality.

Partners (Co-applicants).

Alda The European association for local democracy.

The European Association for Local Democracy is a non-governmental organization, established in 1999 at the initiative of the Congress of Local and Regional Authorities of the Council of Europe, dedicated to the promotion of good governance and citizen participation at the local level. ALDA in particular promotes activities that facilitate the cooperation between local authorities and civil society. ALDA is a membership based organization gathering more than 150 members (including Local Authorities, Associations of Local Authorities and non-governmental organizations) coming from more than 30 countries across wider Europe.

Confesal *Confederación Empresarial de Sociedades Laborales de España.*

Applicant-Coordinator of the project. Confederación Empresarial de Sociedades Laborales de España, is the organization representing different territorial organizations owned companies in Spain. It is composed of 16 regional. Its aims are to represent and defend the interests of such worker-owned companies and to promote the creation of businesses and jobs. It develops training programs for young, unemployed, qualification for corporate employees. Also European projects that drive employee participation in the company, employment of disadvantaged groups, and transmission business for generational change. Projects to promote good practices in social dialogue and social economy at EU level.

Diesis

Diesis, coop is a non-profit European Research and Development Service for the Social Economy, Cooperatives, and participative Enterprises. Its mission is to support the development of the social economy and, in particular, of cooperatives and social enterprises in Europe and in the world via the implementation of knowledge-based activities, such as training, project design, consulting and advisory services, technical assistance and research.

Its members are enterprises, federations, advisory and development groups, as well as organizations specialized in the know-how transfer recognized as being part of the social economy in Europe and worldwide. DIESIS members benefit from a network with over 80,000 enterprises all over Europe

Reves Réseau Européen des Villes & Régions de l'Économie Sociale.

Réseau Européen des Villes en Régions de l'économie Sociale Aisbl. Reves Aisbl Reves is a European network based on partnership between local authorities and social economy. Its membership is composed of local/regional authorities and local social economy. REVES has, among its objectives: establish a dialogue with the European and international Institutions in order to create positive conditions for the development of social and solidarity based-economy; develop social responsibility and exchange expertise and know-how, and to implement innovation in the fields of inclusion, participation and empowerment of local communities; educate and communicate the contribution of social economy-based partnership for more solidarity based communities and pursue these objectives in Europe and at international level with a view to territorial cohesion, international solidarity, promotion of equal opportunity and north-south cooperation.

Scuola Nazionale Servizi **Cultura del Lavoro**

Scuola Nazionale Servizi Foundation. SNS Foundation is a Foundation for applied research, management consulting, teaching and training for enterprises, Public Administrations and purchasers of outsourced services. The SNS mission is to improve the company and labour culture in the service sector for private and public communities, working in the area of training, business support, research and innovation for FM companies and social economy sector development. Among its 55 members, there are LegacoopServizi (National Association representing more than 2,500 social and service cooperatives) FISE Confindustria, C.N.S., Aris Formazione e Ricerca, Active Citizenship Italia (National Association of consumers and citizens), ANMDO (National Association of Physicians and Hospital Management) and AFIDAMP SNS also enjoys a full working relationship with ONBSI-Bilateral National Integrated Service Body (Trade Unions and Entrepreneurial Associations).



Objective.

The general objective of this project is to identify and exchange Good Practices regarding the policies and actions in the sector of Personal and Household Services carried out by local, regional or national Governments and stakeholders of the countries involved in the project, taking into account their specific framework in terms of legislation, social dialogue, methods of coordination, innovation support system, new technologies, new work organizations... as a way to define Policies and Actions to encourage the quality and the efficiency of these services and to contribute through the creation of new jobs to the objectives of European 2020 Strategy.

The project will encourage new forms of collaboration through partnerships between public and private actors in the labor market.



Activities.

The core of the project is to identify and exchange good practices all over Europe regarding the policies and actions in PHS sector and to define a Policies and Actions Proposal and methodology to encourage the efficiency of these services:

- ★ To define the criteria to identify good practices of policies and actions developed in the Personal and Household Services Sector in terms of efficiency.
- ★ To identify relevant stakeholders of the country partners.
- ★ To collect good practices in PHS sector and elaborate a Guide of good practices in PHS sector.
- ★ To Analyzed and categorize the good practices and

to elaborate a Guide with the proposal of Policies and Action and a methodology of implementation and Proposals Guide

- ★ To transfer the results

The project will be disseminated through different means, in order to involve stakeholders, relevant policy-makers, institutions, social civil...

- ★ Newsletters, web and social networks
- ★ Presentation Workshops of the project in Belgium, Italy and Spain
- ★ Final seminars for global dissemination and transference purposes in Belgium, Italy and Spain



Target Groups.

Different groups can benefit from the project:

- ★ Policymakers, at local, regional and national level.
- ★ Non-profit associations,
- ★ Companies working in the PHS Sector, mainly belonging to Social economy.
- ★ Experts and workers with beneficiaries of PHS activities.
- ★ Civil Society.
- ★ Regional, National and International Authorities. They are in charge of assuming the proposals of the project and to contribute to the transfer the results.
- ★ National and European Trade Unions.



Duration / Budget and funding.

The project has a duration
of 18 months.
From 31st October 2014
to 29 th April 2016

The total cost of the project 296.338,85 €.
It has an European Union funding
of 237.071,08 € (80%), from the Programme
for Employment and Social Solidarity
PROGRESS.

confesal

sociedades laborales
de España

Confesal, Confederación Empresarial de Sociedades Laborales de España

Address C/ Vallehermoso, 15 - 1º
Postal code 28015
City Madrid
Country ES - Spain
Telephone +34 91 444 09 70
Fax + 34 91 444 09 74
E-mail addressconfesal@confesal.es
Web site www.confesal.es



ALDA The European Association for Local Democracy

Address. c/o Maison des Associations,
1/A Place des Orphe
Postal code67000
CityStrasbourg
Country FR - France
Telephone+33 3 90 21 45 93
Fax+33 3 90 21 55 17
e-mail aldo.xhani@aldaintranet.org
Web site www.alda-europe.eu

REVES

Réseau Européen des Villes et Regionsde Leconomie Sociale AISBL. REVES AISBL

Address Boulevard Charlemagne 74
Postal code 1
City BRUSSELS
CountryBE - Belgium
Telephone +3222308810
Fax+3222304618
E-mail address . office@revesnetwork.eu
Web site www.revesnetwork.eu



Scuola Nazionale Servizi Foundation.SNS

Foundation

Address Strada Santa Lucia, 8
Postal code 06125
City Perugia
Country IT - Italy
Telephone +39 075 5845139
Fax +39 075 5848054
E-mail address info@scuolanazionalesestivi.it
Web site www.scuolanazionalesestivi.it



Diesis, coop. Diesis

Address Square de Meeûs 18,
Postal code 1050
City Brussels
Country BE - Belgium
Telephone 003225431043
Fax 003225410569
E-mail address Diesis@diesis.coop
Web site www.diesis.coop

This Project is supported by the European Union Programme for Employment and Social Solidarity - PROGRESS (2007-2013).

This programme is implemented by the European Commission. It was established to financially support the implementation of the objectives of the European Union in the employment, social affairs and equal opportunities area, and thereby contribute to the achievement of the Europe 2020 Strategy goals in these fields.

The seven-year Programme targets all stakeholders who can help shape the development of appropriate and effective employment and social legislation and policies, across the EU-28, EFTA_EEA and EU candidate and pre-candidate countries.

The information contained in this publication does not necessarily reflect the position or opinion of the European Commission.*

